

GEN. TOLERANCES	0.5 - 6	±0.1	6 - 30	±0.2	30 - 120	±0.3	120 - 315	±0.5	315 - 1000	±0.8	1000 - 2000	±1.2	2000 - 4000	±2	4000 - 8000	±3
GEN. MACHINING		0.4		1.6		3.2		6.3		12.6	25 ROUGH					

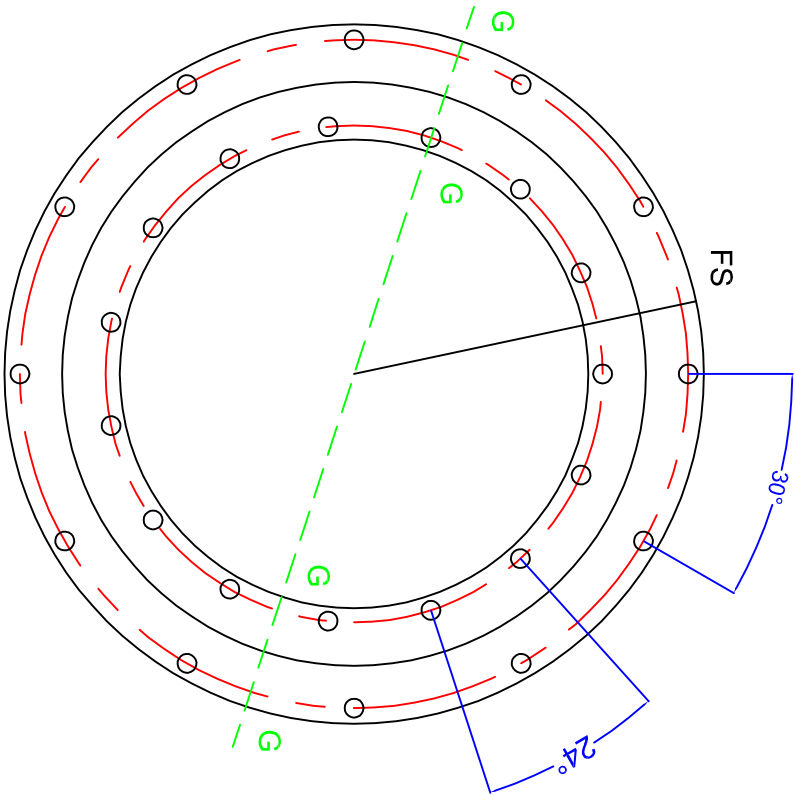
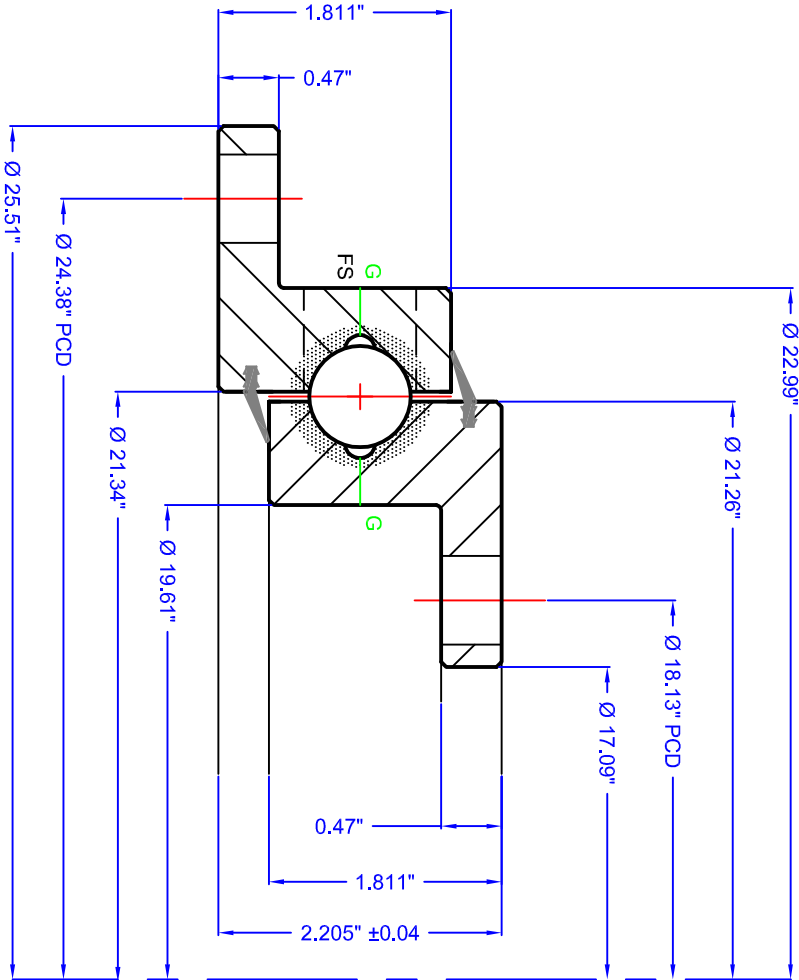
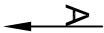

VIEW ON 'A' SHOWING DRILLING PATTERN AND OTHER DETAILS

GEAR DATA										Designed in accordance with designated QCB SLEWING RING STANDARDS									
HARDENED GEAR		MODULE (m)								Non tolerated dimensions to ISO 2768-1 m									
NUMBER OF TEETH (Z)		DP								All burrs and sharp edges to be removed; Standard corner chamfer 1mm x 45°									
PRESSURE ANGLE (α)										Internal radial and axial clearance figures to QCB standard 2014 or revisions thereof									
ADDENDUM COEFFICIENT (X)										The HARDNESS GAP is to be indicated by stamped letter R or a PAINT mark on the exterior surface									
PROFILE CORRECTION (Y)										The high point of gear eccentricity to be indicated by GREEN or BLUE paint on 3 teeth									
CALCULATED GEAR STRENGTH										BOLT DATA									
TRUNCATION (mm)		F _z (Normal)		KN		INNER	15 =	MOUNTING HOLES	Ø0.69"		AXIAL PLAY		0.10-0.22 mm		TURNING TORQUE		Nm		
PITCH CIRCLE DIAMETER		F _z (Max)		KN		OUTER	12 =	MOUNTING HOLES	Ø0.69"		RADIAL PLAY		0.10-0.22 mm		MATERIAL		50Mn		
MEASUREMENT ON K TEETH		Pin Diameter		mm		GREASE HOLES	G'	(2+2) 1/4"-28 UNF			WEIGHT		35 kg (ssst)						
RUNOUT NOT HARDENED/HARDENED						LOADING PLUG	'FS'	SOFT ZONE	R'		SEAL SIZE		TBA						
© NBC GROUP LTD. NOT TO BE COPIED WITHOUT PERMISSION																			

1

REV

DATE

MODIFICATION

REVISED BY

QCB

Bearings

SLEWING

RINGS &

DRIVES

Imported by NBC Group Ltd

Orleton Lane, Wellington, Telford, TF1 2BG, UK

P: 01952 222300 F: 01952 242938

www.nbgroup.co.uk

QCB® is a registered trademark of NBC Group Ltd

QCB RS 11/2016

FUN 648 20 61 CC LM

DATE: 13/05/2016

CHECKED: LJM