

GEN. TOLERANCES		0.5 - 6	±0.1	6 - 30	±0.2	30 - 120	±0.3	120 - 315	±0.5	315 - 1000	±0.8	1000 - 2000	±1.2	2000 - 4000	±2	4000 - 8000	±3
GEN. MACHINING		0.4		1.6		3.2		6.3		12.6		25 ROUGH					

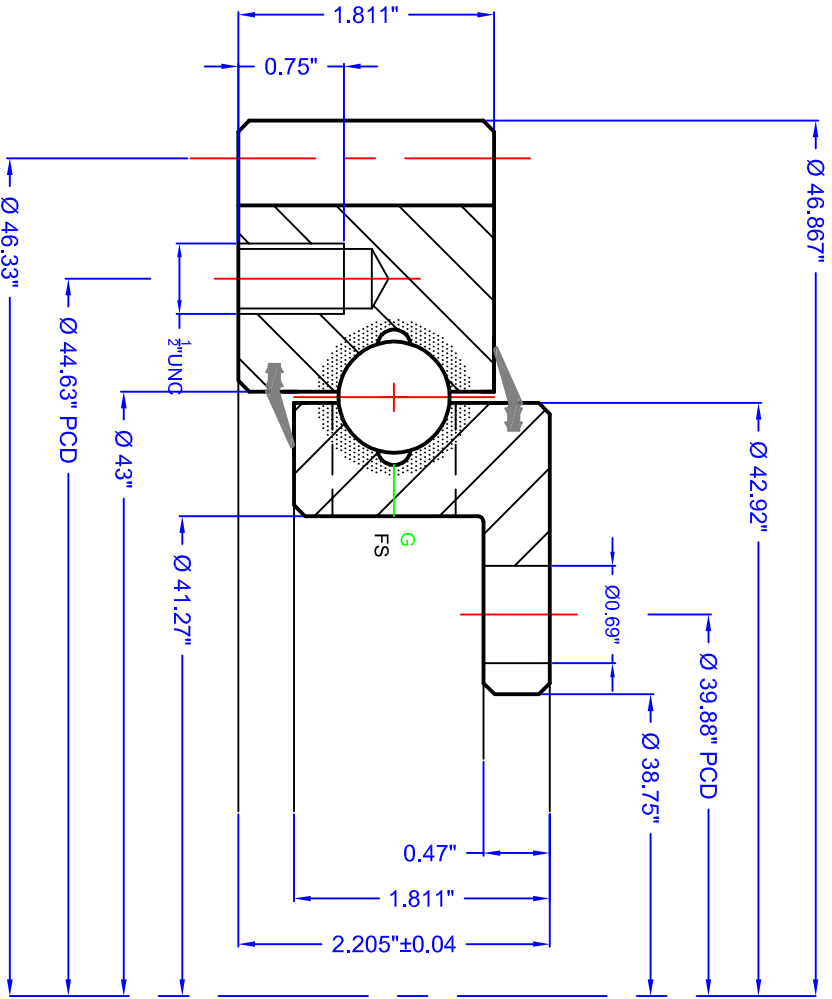

GEAR DATA		SPUR		DESIGNED IN ACCORDANCE WITH DESIGNATED QCB SLEWING RING STANDARDS	
HARDENED GEAR	NO	MODULE (m)		Non tolerated dimensions to ISO 2768-1 m	
NUMBER OF TEETH (z)	139	DP	3	All burrs and sharp edges to be removed; Standard corner chamfer 1mm x 45°	
PRESSURE ANGLE (α)	20°			Internal radial and axial clearance figures to QCB standard 2014 or revisions thereof	
ADDENDUM COEFFICIENT (x)				The HARDNESS GAP is to be indicated by stamped letter R or a PAINT mark on the exterior surface	
PROFILE CORRECTION (mm)				The high point of gear eccentricity to be indicated by GREEN or BLUE paint on 3 teeth	
CALCULATED GEAR STRENGTH		BOLT DATA			
TRUNCATION (mm)		INNER	24 =	MOUNTING HOLES	Ø0.69"
PITCH CIRCLE DIAMETER	46.333"	OUTER	20 =	MOUNTING HOLES	Ø1.125 UNC
MEASUREMENT ON K TEETH	mm	GREASE HOLES	G'	4 X 1"-28 UNF	
RUNOUT NOT HARDENED/HARDENED		LOADING PLUG	F'S	SOFT ZONE	R'
© NBC GROUP LTD. NOT TO BE COPIED WITHOUT PERMISSION		SEAL SIZE	TBA		

VIEW ON 'A' SHOWING DRILLING PATTERN AND OTHER DETAILS

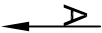
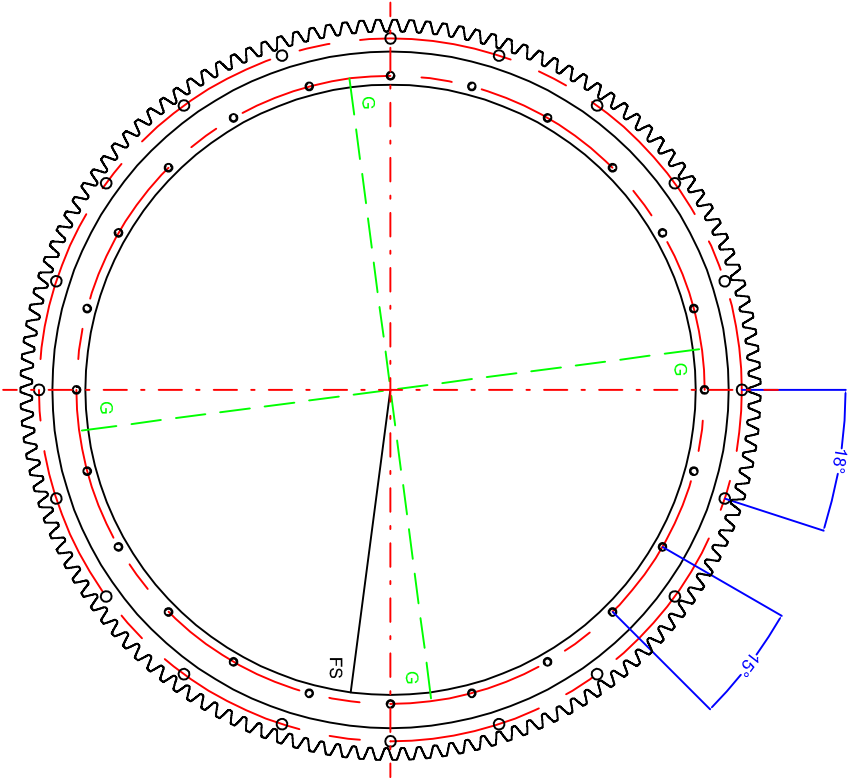

REV	DATE	MODIFICATION	REVISD BY
1			
		QCB Bearings SLEWING RINGS & DRIVES	
		Orleton Lane, Wellington, Telford, TF1 2BG, UK	
		P: 01962 222300 F: 01962 242938	
		www.nbcbgroup.co.uk	
		QCB® is a registered trademark of NBC Group Ltd	
		DRAWN: LW	
		DATE: 23/05/2016	
		CHECKED: LLM	
		QCB RS 11/2016	



FEEG 1190 20 61 AA LM