

GEN. TOLERANCES	0.5 - 6	±0.1	6 - 30	±0.2	30 - 120	±0.3	120 - 315	±0.5	315 - 1000	±0.8	1000 - 2000	±1.2	2000 - 4000	±2	4000 - 8000	±3
GEN. MACHINING	✓	0.4	✓	1.6	✓	3.2	✓	6.3	✓	12.6	✓	25 ROUGH	✓			

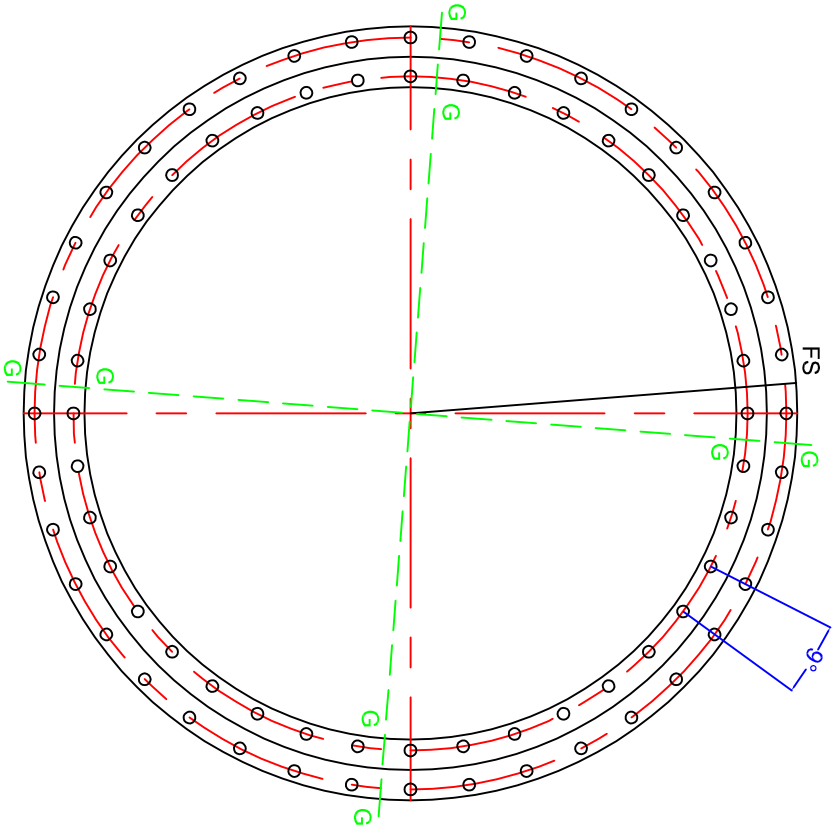

VIEW ON 'A' SHOWING DRILLING PATTERN AND OTHER DETAILS

GEAR DATA		Non tolerated dimensions to ISO 2768-1 m		Designed in accordance with designated QCB SLEWING RING STANDARDS	
HARDENED GEAR		All burrs and sharp edges to be removed; Standard corner chamfer 1mm x 45°		Internal radial and axial clearance figures to QCB standard 2014 or revisions thereof	
NUMBER OF TEETH (z)	MODULE (m)	The HARDNESS GAP is to be indicated by stamped letter R or a PAINT mark on the exterior surface		The high point of gear eccentricity to be indicated by GREEN or BLUE paint on 3 teeth	
PRESSURE ANGLE (α)	DP				
ADDENDUM COEFFICIENT (x)					
PROFILE CORRECTION (y)					
CALCULATED GEAR STRENGTH		BOLT DATA			
TRUNCATION (mm)	Fz (Normal)	INNER	40 =	MOUNTING HOLES	Ø 14
PITCH CIRCLE DIAMETER	Fz (Max)	OUTER	40 =	MOUNTING HOLES	Ø 14
MEASUREMENT ON K TEETH	Pitch Diameter	GREASE HOLES	G'	2 X 4 M8	WEIGHT
RUNOUT NOT HARDENED/HARDENED		LOADING PLUG	'FS'	SOFT ZONE	'R'
© NBC GROUP LTD. NOT TO BE COPIED WITHOUT PERMISSION		SEAL SIZE	TBA		
		AXIAL PLAY	0.12-0.28 mm		
		RADIAL PLAY	0.12-0.28 mm		
		TURNING TORQUE	Nm		
		MATERIAL	50Mn		
		WEIGHT	61 kg (est)		
		REPT OF (assembling)	mm		

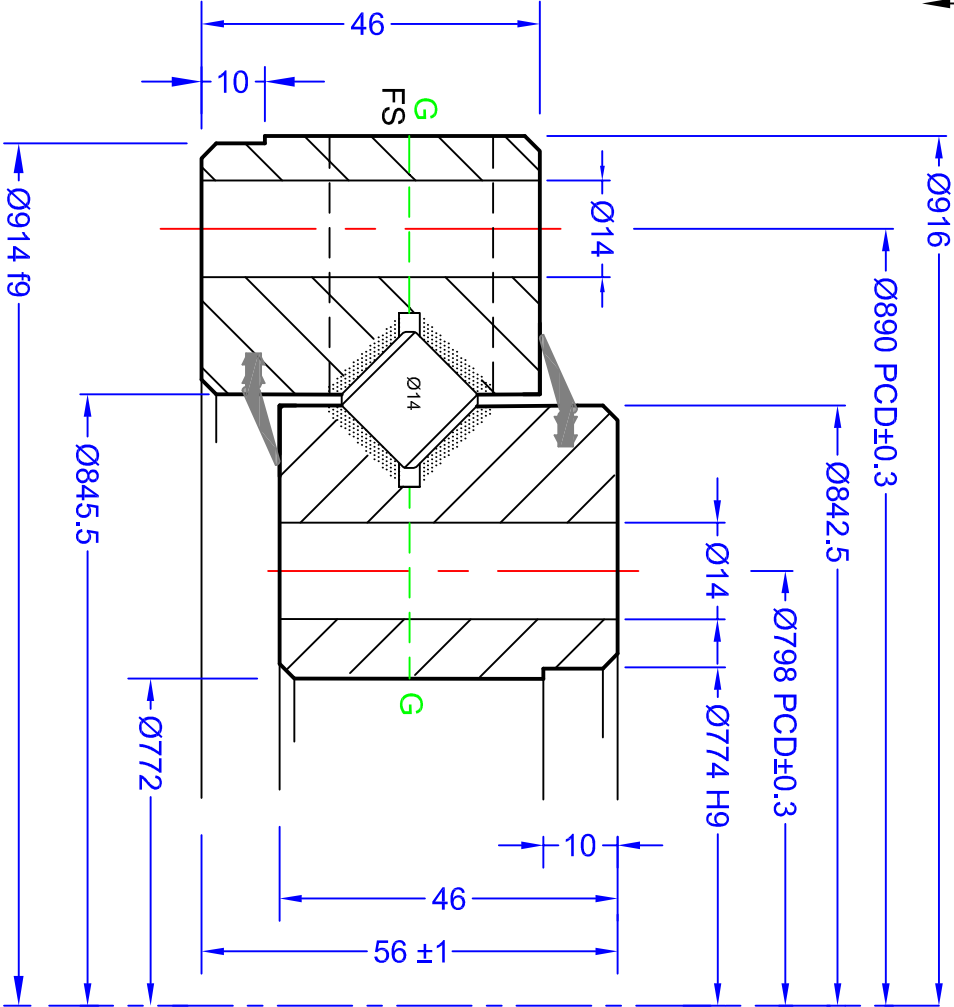
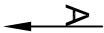

SLEWING RINGS & DRIVES

Orleton Lane, Wellington, Telford, TF1 2BG, UK
P: 01962 222300 F: 01962 242938
www.nbcbgroup.co.uk

SUN 916 X14 01 CC LM

QCB® is a registered trademark of NBC Group Ltd
QCB RS 11/2016

DRAWN:	LJM
DATE:	21/2/2015
CHECKED:	LJM